

5 | Specifications

D. LR20 Powerline

1. Battery Identification

Name:	XL / LR20 / AM1 / D / MN 1300
Type:	alkaline / foil
Nominal Voltage:	1.5 V
Electrolyte:	KOH (potassium hydroxide)
Average Weight:	137.7 g

Manufactured by PBBE

2. Battery Dimensions

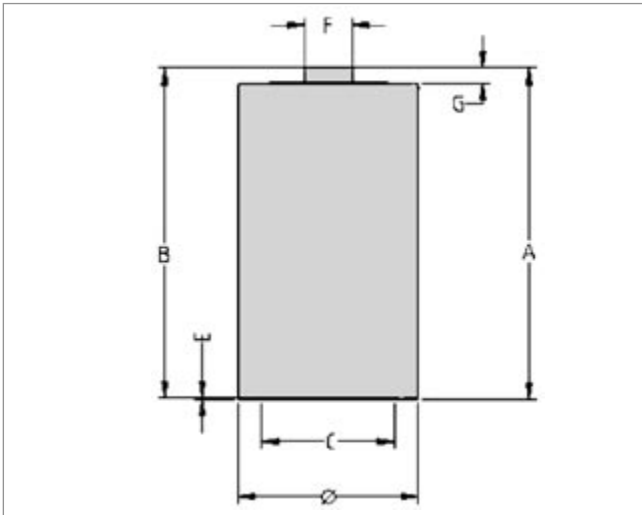

Dimension (mm)	Max.	Min.	Typical
A	61.5		60.6
B		59.5	60.3
C		18.0	24.2
E	1.0		0.3
F	9.5		8.7
G		1.5	2.5
ø	34.2	32.3	33.0

3. Battery Performance

TEST	DRAIN	DAILY PERIOD	END POINT	TYPICAL	MIN AVG
Radio	10 ohm	4 h	0.9 V	120 h	101 h
Stereo	600 mA	2 h	0.9 V	16.3 h	12.5 h
Motor	2.2 ohm	1 h	0.8 V	23.0 h	19.9 h
LIF*	2.2 ohm	4 min/h - 8 h/d	0.9 V	1450 min	1291 min
HIF**	1.5 ohm	4 min/15min - 8h/d	0.9 V	920 min	770 min

* Low Intensity ** High Intensity

Typical Discharge Values

4. Discharge Curves

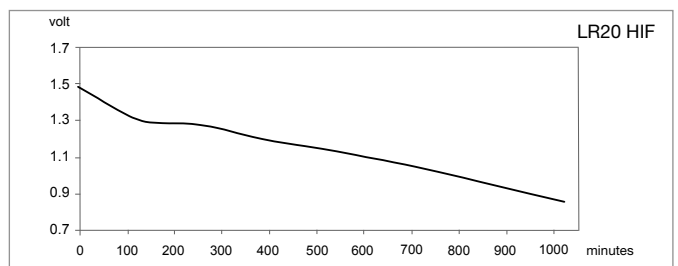
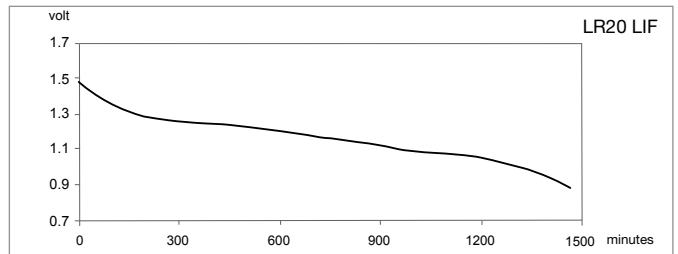
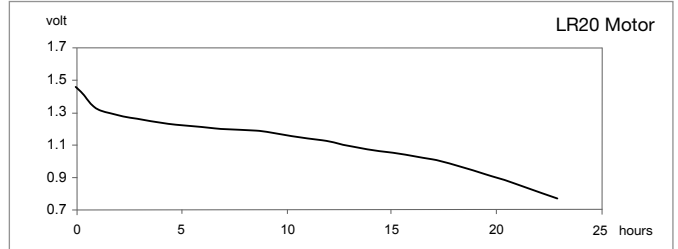
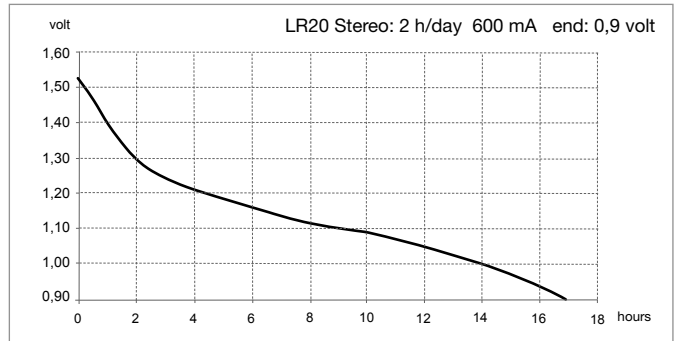
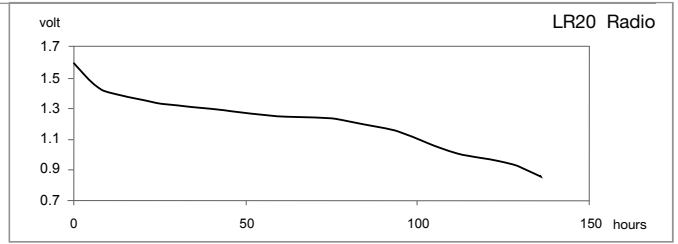

5. Product Safety Data Sheet

Item	Material	% (Weight)
Total Weight		135.8 g
Cathode	MnO ₂ /C	49 %
Anode	Zn/KOH	27 %
Separator	Paper	1 %
Current Collector	Brass	1 %
Electrolyte	KOH/H ₂ O	7 %
Steel Can	Ni plated steel	11 %
Bottomplate	Ni plated steel	2 %
Label	PVC	2 %

No Mercury (Hg), Cadmium (Cd) or Lead (Pb) are used in the battery.